

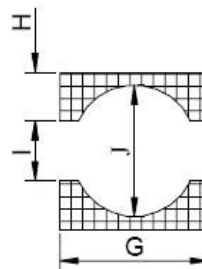

# Qian Hong Electronics Co.,Ltd.

## MECHANICAL DIMENSIONS(mm):

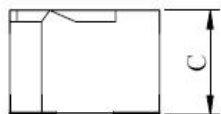
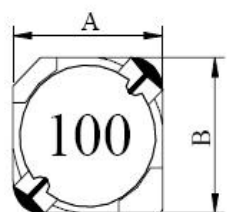

A: 7.00 Max.  
 B: 7.00 Max.  
 C: 4.00 Max.  
 F: 2.50 Typ.  
 G: 7.30 Ref.  
 H: 2.40 Ref.  
 I: 2.40 Ref.  
 J: 6.00 Ref.

## ELECTRICAL CHARACTERISTICS:

MODEL NO	L(uH)	Test Freq.(kHz)/1V	DCR Max.(mΩ)	Rated Current(A)
SD7040-3R0Y	3.0±30%	10	21.0	3.50
SD7040-5R0Y	5.0±30%	10	25.0	2.90
SD7040-6R8M	6.8±30%	10	30.0	2.50
SD7040-8R2M	8.2±30%	10	36.0	2.30
SD7040-100M	10±20%	10	50.0	2.00
SD7040-120M	12±20%	10	55.0	1.70
SD7040-150M	15±20%	10	60.0	1.60
SD7040-180M	18±20%	10	75.0	1.50
SD7040-220M	22±20%	10	87.0	1.30
SD7040-270M	27±20%	10	105.0	1.20
SD7040-330M	33±20%	10	120.0	1.10
SD7040-390M	39±20%	10	135.0	1.00
SD7040-470M	47±20%	10	160.0	0.95
SD7040-560M	56±20%	10	190.0	0.86
SD7040-680M	68±20%	10	240.0	0.75
SD7040-820M	82±20%	10	290.0	0.70
SD7040-101M	100±20%	10	345.0	0.65

1. Rated Current Base on  $\Delta L/L0A=35\%$  typ. 2.  
 Rated Current Base on temp rise 40°C typ.